

7100

Electric Strike for Single Leaf Aluminium Doors



The Adams Rite 7100 Series is for remote use access control of any door equipped with Adams Rite 4700 series (or similar) deadlatch.

The 7100 has flat faceplates for installing in the frame of a single action single leaf doors.



Key Benefits

- Suitable for use on aluminium doors
- Facility to change duty from fail-safe to fail secure and vice-versa
- Non-handed
- The compact mechanism fits into an aluminium jamb section as shallow as 44.45mm
- Electrical actuation unlocks the strike jaw, releasing the latchbolt so the door can be opened without operating the latch itself
- The 7100 series have flat faceplates for mounting in the frame of a single action single leaf doors.
- 907kg holding force (2000lbs)
- Round corners of faceplate to aid installation into aluminium doors

Related Hardware

RiteKey Keypad ~ Push-to-Exit Button ~ Power Supply Unit ~
4710 Deadlatch ~ 4750 Deadlatch

Note: For out of hours security specify the Sentinel 6 Deadlock in conjunction with the electric strike/latch combination.

Dimensions

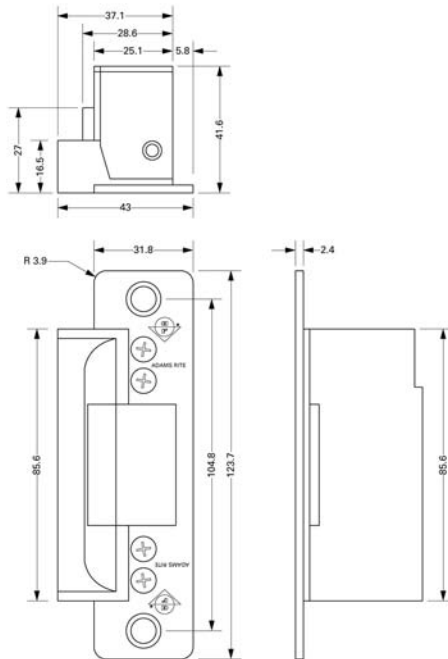

Specifications

Current Draw:	12vAC=1.48A, 12vDC=0.332A, 24vAC=0.74A, 24vDC=0.19A (nominal). DC intermittent and continuous units are silent, AC intermittent units "buzz" on operation.
Voltage Tolerance:	±10%.
Powered By:	Internal solenoid.
Monitoring:	(Optional) Single: Latch only, Double: Latch & solenoid.
Duty:	Fail-safe or fail-secure (convertible without additional parts). DC power supply required for fail-safe operation.
Jaw Strength:	907kg (2000lbs).
Case:	85.6mm x 28.6mm x 41.6mm. Zinc aluminium alloy.
Mechanism:	Stainless steel internal blocking mechanism.
Strike Opening:	36.5mm x 15.9mm x 12.7mm. Stainless steel bolt retainer jaw.
Door Gap:	Minimum 3mm (1/8"), operational door gap 3-5mm.
Faceplate:	Aluminium. 123.7mm x 31.8mm. Flat.
Finishes:	See ordering codes.
Subcover:	Basic subcover lip will suit a 44.45mm (1 3/4") thick door that closes flush with jamb edge. For extended bolt-on subcovers see ordering codes.
Standards:	ANSI/BHMA 156.5 Grade 1. UL Listed for burglary resistance.

Ordering Codes Matrix

7100 - 3 1 0 - 628 - 1

Model Number

7100

Voltage

3 12 volt

5 24 volt

Current and Duty

1 DC Continuous

or intermittent

4 AC Intermittent (fail-secure only)

Features

0 Standard/Fail-Secure

5 Standard/Fail-Safe

7 Monitored/Fail-Safe

9 Monitored/Fail-Secure

Finish

628 Satin Aluminium

313 Bronze

335 Black

Options

1 Single Monitoring (Latch only)

2 Double Monitoring (Latch and Solenoid)

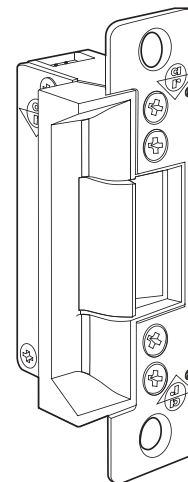

Subcover Extension Codes (order separately)

Order Code	Dimension*	Order Code	Dimension*
91-0171-01	38.1mm (1.50")	91-0171-08	60.5mm (2.38")
91-0171-02	41.4mm (1.63")	91-0171-09	63.5mm (2.50")
91-0171-03	44.5mm (1.75")	91-0171-10	66.8mm (2.63")
91-0171-04	47.8mm (1.88")	91-0171-11	69.9mm (2.75")
91-0171-05	50.8mm (2.00")	91-0171-12	73.2mm (2.88")
91-0171-06	54.1mm (2.13")	91-0171-13	76.2mm (3.00")
91-0171-07	57.2mm (2.25")		

*Dimension from door centreline to jamb edge.